

INFINITI

HOLOSUN

HS402C

Red Dot Sight User's Manual

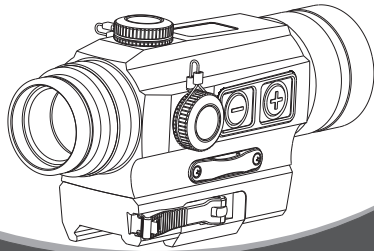

Solar Drive

www.holosun.com

Thank you for purchasing the INFINITI HS402C Red Dot sight, which is a monocular inner red dot sight, please read the User's Manual carefully.

Features

1. Aiming secretly: aiming with the inner red dot in sight, no light can be detected by sighted object.
2. Full field of view for target aiming: Aiming with two eyes open, rapid target acquisition and environment control.
3. Solar power supply: The device is driven by solar power (silicon solar cell), power is ready for use all the time.
4. Two-path-power supply design: it can be shift to normal battery supply under dark surrounding.
5. Under daylight condition, LED is powered by solar cell, lightened constantly and is ready for use at anytime.
6. Low power consumption: Only several microamperes current for sight operation. Working life with one battery can be 30000 hours, No need for caring replace the battery.

1

7. Parallax free of optical system. Target mark (dot) parallax $\leq \pm 1$ MOA.
8. Auto power turn-off: The power of device will be automatically turned off after 8 hours' non-operation (operation stagnation).
9. Brightness adjustment: 12 setting for brightness of target mark with different ambient light conditions.
10. One Button switch: Easy operation, reduce obstruction to vision.
11. Quick mounts: The adopted nonlinear cam Quick clamp mount system can be easily and fast mounted on arms with out any other tools help.
12. Waterproof: Ip67

Model

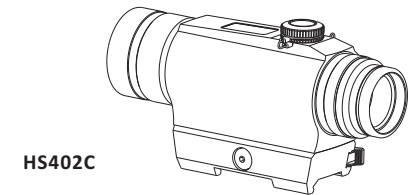

HS402C

Fig1

*INFINITI HS402C

2

Important notices

1. You must check carefully and make sure for 100% to unload the bullet from your firearms before any actions taken such as device installation, beam adjusting or changing new battery. Ensure all the operation is under safe condition.
2. Please keep the inner package for future maintenance mailing purpose. Other packaging material may be disposed properly.

Battery

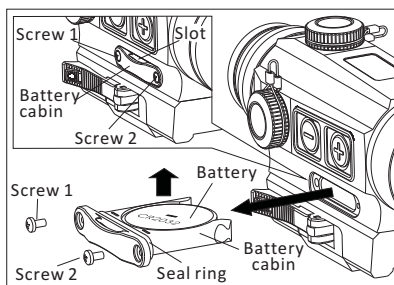

Fig 2-1

3

1. Operates with two-way power supply (solar cell and internal battery). The operating voltage for this device is DC3V using one high quality CR2032 Lithium battery included with purchase.
2. The high quality battery can power the device for

up to 30,000 hours. Caution: The battery is not rechargeable.

3. Battery replacement:

- 1) Removing the battery (Fig 2-1):
 - a) Unfasten screw 1,2.
 - b) Insert coin or similar object in the battery tray slot, pry out the battery tray, and remove the discharged battery by lifting it up.
- 2) Battery installation (Fig 2-2):
 - a) Insert the battery into the battery tray by pushing it down with the correctly marked polarities, "+" and "-".
 - b) Insert and press the tray into the battery compartment.
 - c) Fasten screw 1,2.

4

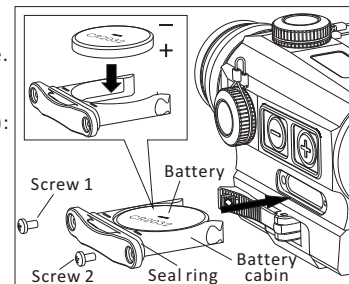

Fig 2-2

Caution:

The loss or damage of seal ring will cause the water leaking into compartment and may damage electronic circuits and the device.

Installation

1. The mount bracket is adaptable to the arms with Picatinny Rail, if the arms have no Picatinny rail, or with other types of rail, Please make extra remarks in your purchase order.
2. Designed with our patented nonlinear cam clamping technique, without other tools for mounting rail, push back the locker, life up hand shank to loosen the convex set, Inserting the device on rail, push down the hand shank, locker will be auto locked, the installation complete. (see fig 3)
3. Initial installation

For the first installation, You may feel the clamp too tight that the hand shank cannot be pushed down or too loose that the device cannot be clamped tightly on rail, you need to make a little adjustment for the clamp. The following is the adjustment steps:

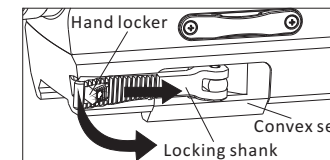

Fig3

5

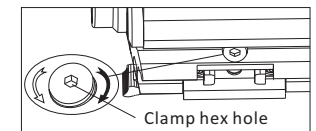

Fig4

- ① There is one hex hole at the end of clamp adjusting screw by the side of device. (See Fig4), before installation, Left rotating screw to loose the convex set with hex spanner, and than.
- ② Pull up the CAM clamp hand shank. Slid the sight in rail, close the clamp hand shank.
- ③ Right rotate the adjusting screw hole by hex spanner, tighten Convex set with rail to moderate degree. Try to pull up and close the hand shank, adjusting the clamp screw to appropriate degree, neither too tight nor too loose, and can be avoid to loose under recoil shock.

Sight operation

Two operation modes are available: Auto mode and manual mode.

1. Auto mode (default)

- with solar cell and internal battery two-way power supply:

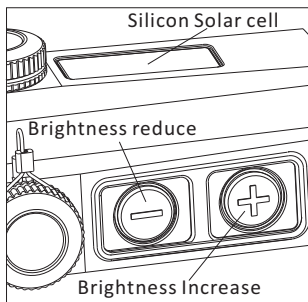

Fig5

6

Based upon the ambient lighting level, the sight will switch between battery and solar cell power automatically for operation in all lighting conditions.

Auto mode operation:

- a) Sight is always in auto mode unless specifically switched to manual mode.
- b) While in auto mode, the brightness of the reticle is automatically adjusted to match ambient lighting. The brighter it is, the higher the dot intensity.
- c) If lighting is low enough, the sight will automatically switch to the battery. While running on battery, you can adjust the reticle brightness using the "+" and "-" buttons to switch between levels 3, 4, or 5.

2. Manual Mode (Internal battery power only mode):

- a) Press down the "+" button for 3 seconds to enter into the Manual Mode.
- b) Brightness adjustment: There are 12 settings for reticle brightness level under manual mode. The default brightness is at 7 when the device is switched to this

7

Maintenance and care

This device is a precision instrument that deserves reasonably cautious care. The following tips are provided to ensure long lasting use of the sight.

The optical system including the objective window and eyepiece lens which are multi-coated optical glass. When cleaning the lenses, blow away the dust on surface, wet the lens with lens cleaner or clean water, wiping the fingerprint and oil stain with lens tissue, soft cotton or microfiber cloth. No special maintenance needed for housing surface. Avoid touching the glass surface with dry cloth or tissue paper. No organic solvents such as alcohol, acetone are allowed. Don't try to dismantle the device as the internal parts are specially cleaned and sealed and with anti-fog treatment, Any such attempt will void the warranty.

If repair needed, you can call our customer service center, or login in our website, or send email to us.

Limited warranty

SUMMARY

We provide limited lifetime warranty from the date of purchase on

10

mode. The brightness can be adjusted as required by pressing the "+" or "-" to increase or decrease the brightness level, one press for one change in brightness level.

c) Switching back to auto mode:

Simultaneously press the "+" and "-" buttons to switch to auto mode. The device will also switch automatically from manual mode to auto mode if there has been no other button operation in 12 hours.

Note: In summary, the sight is always ready for use, no matter what the lighting conditions are.

Zero setting

1. On top of sight is the elevation adjusting knob, windage adjusting knob is on the right side (see Fig6) The sight has been primarily adjusted in factory.
2. First open the protective lid (see Fig6), position slot type screwdriver on the slotted screw, then rotate the screw to right or left for adjustment. Each left or right click is for one shift

8

moving equivalent to 0.5 MOA value.

3. Right turning the elevation knob will moving the red dot up, left turning will lower the red dot. Similar for the windage adjusting, right turning will move the red dot to right, left turning will move it to left.

4. **Caution:** Don't try to rotate the knobs, if you feel the knobs cannot be rotated which proves the adjustment limits. Otherwise the device may be damaged. If the adjusting range is beyond the limits, consider to add extra spacer between the device and mount rail to expand the adjusting angle limits.

Fig 6

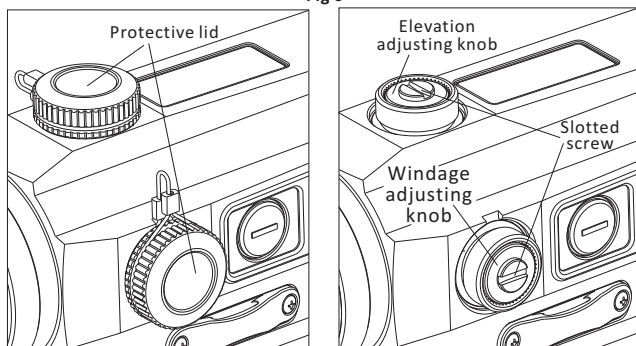

9

parts and workmanship to the original purchaser. At our sole discretion, we will repair or replace product found to be defective under normal use and service without charge excluding any delivery costs, which will be born by purchaser.

We will not be liable for incidental, consequential, or special damages arising out of or in any connection with the use or performance of this product. This warranty is void if the product has been misused, modified, neglected, or disassembled prior to its return.

Please refer to <http://www.holosun.com> for current and complete warranty information.

**INFINITI HS402C
Red Dot sight**

HOLOSUN
Holosun Technologies Inc.
www.holosun.com



Customer Service

Phone: 909-594-2888

Email: info@holosun.com

11

v2.0